

PETROLEUM CANOPY RETROFIT KIT

SCRT SERIES

Sleek, bright, efficient, and a DesignLights Consortium™ Premium Qualified Product, this upgrade for **LSI Industries' Scottsdale†** petroleum canopy fixtures is the *fastest and easiest installation in the industry!*

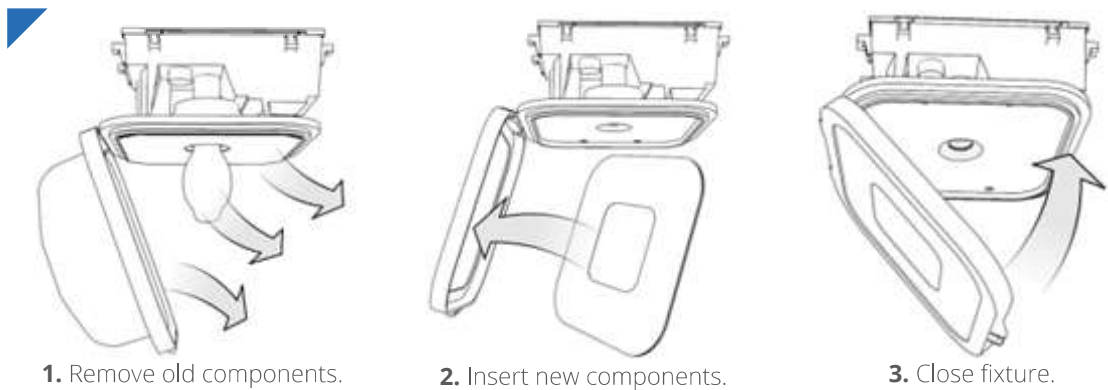

CONSTRUCTION & COMPATIBILITY

- Heavy duty, high efficiency LEDs
- Aluminum LED panel removes heat from LEDs
- High rise driver lid included for power supply installation
- Fastest, easiest, and cleanest looking installation in the industry
- **Over 135 lumens per watt!**
- Available with 0-10V dimming capability - see ordering chart below

ELECTRICAL & LIGHT OUTPUT SPECIFICATIONS

MODEL	# LEDS	INPUT	POWER	LUMENS	CCT	CRI	PF
SCRT-320	4	120-277V 50/60 Hz	107W	14,680 lm	5000K	>72	>.9

ORDERING CHART

PRODUCT FAMILY

SCRT SERIES:
SCOTTSDALE† RETROFIT KIT

METAL HALIDE EQUIVALENT

320 (320W equivalent, 107W)

0-10V DIMMING

(no 0-10V dimming standard - leave blank)
DM (0-10V dimming leads required)

* SCRT-320 is a DesignLights Consortium™ Premium Qualified Product. † "Scottsdale" is a registered trademark of LSI Industries, Inc.