

VAP *amore*[®]
THE LOVE OF STEAM

MR750[™]
OTTIMO



STEAM CLEANER
INSTRUCTION BOOK AND USERS GUIDE
Mode d'emploi et manuel de l'utilisateur

SAFETY INFORMATION

GO TO VAPAMORE.COM TO SEE THE MR-750 OTTIMO INSTRUCTIONAL VIDEO



FAILURE TO FOLLOW SAFETY INFORMATION AND WARNINGS MAY CAUSE PERMANENT DAMAGE AND VOID PRODUCT WARRANTY.

1. Do not leave the steam cleaner unattended when plugged in. Unplug from socket when not in use.
2. To prevent electric shock use only with a grounded outlet.
3. Not to be used as a toy. Close supervision is necessary when used near children.
4. Use only as described in this manual.
5. Do not use with a damaged cord or plug. If the supply cord and/or plug is damaged, they must be replaced by Vapamore in order to prevent a fire hazard.
6. Do not pull or carry by the cord, use the cord as a handle, allow the cord to come into contact with hot or sharp surfaces or close a door on the cord.
7. Do not unplug by pulling on the cord.
8. Do not handle the plug or steam cleaner with wet hands.
9. Do not pull or drag steam cleaner using the steam gun and hose.
10. Only carry the steam cleaner by the handle.
11. Turn off all controls before unplugging.
12. Steam cleaner must be level and on the floor during use.
13. Do not use an extension cord.
14. Do not attempt to remove blockages with sharp objects as they may cause damage.
15. Store indoors, put away after use to prevent tripping accidents.
16. Using improper voltage may result in damage to the steam cleaner and possible injury to the user. The correct voltage is listed on the label.
17. Drain water tank prior to shipping, transporting.
18. A hazard may occur if the steam cleaner runs over the power supply cord.
19. Accessories become hot during use - allow them to cool down before handling.
20. Never immerse the steam cleaner in water or other liquids.
21. Keep the steam cleaner away from rain and moisture. The steam cleaner is not suitable for outdoor use around water.
22. Only use the steam cleaner in containers / pools that are not filled with water or other liquids.
23. Do not operate the steam cleaner without water in the tank. Always top off with water when needed.
24. Only use distilled water. Using hard water can cause calcium or mineral build up and void the warranty.
25. Never use additives such as perfumes, stain removers, or other chemicals in the water tank as they will void the warranty, cause permanent damage, and be dangerous.
26. Always remove the main plug from the socket and allow the steam cleaner to cool down completely before storage.
27. Do not overfill the tank. Do not exceed the maximum filling level. Please use the funnel included.
28. Make sure the water tank cap is fully secured before use.
29. Empty the water tank if stored (See cleaning and storage).
30. Do not touch any hot areas on the steam cleaner. It is normal for the steam cleaner to heat up during operation.
31. Do not use the steam cleaner to treat any items of clothing that are still being worn on the body.
32. The force and heat of the steam may have an adverse effect on some materials. Always check whether a surface is suitable for treatment with the steam cleaner by carrying out a test beforehand on a concealed area.
33. Always include these operating instructions if passing the steam cleaner on to a third party.
34. Never aim the steam cleaner at people, animals or plants (risk of scalding)! Do not aim the steam cleaner at electrical systems.
35. Do not leave the steam cleaner on and unattended. Always switch the steam cleaner off and remove plug from wall outlet when unattended.
36. The steam cleaner is fitted with a thermostat and a thermal cut-out as protection against overheating.

PARTS OVERVIEW

GO TO VAPAMORE.COM TO SEE THE MR-750 OTTIMO INSTRUCTIONAL VIDEO

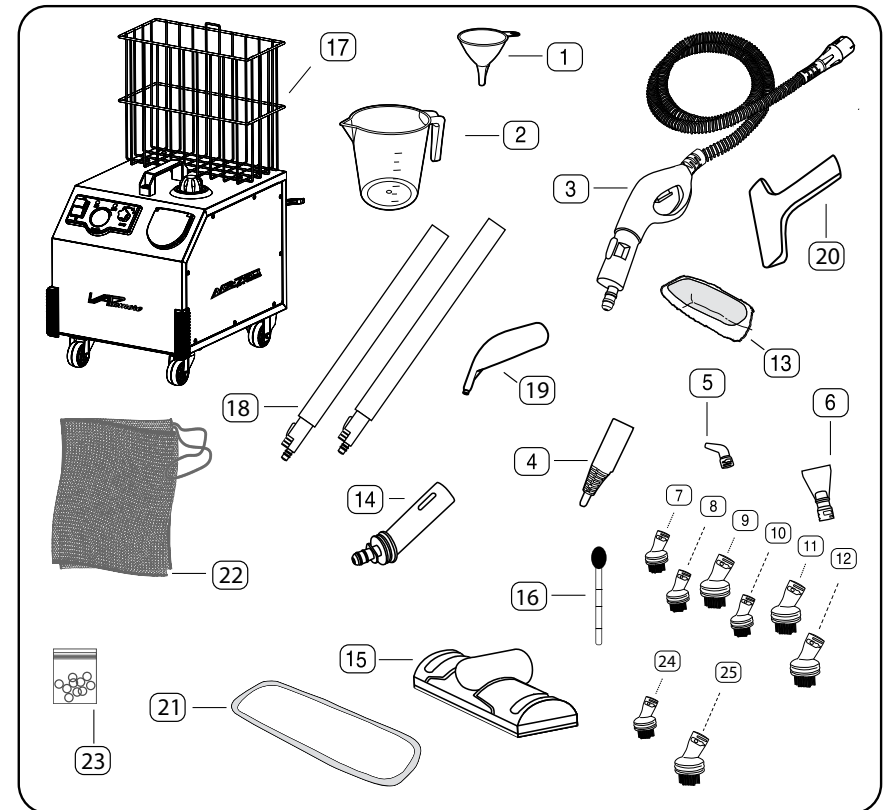

PARTS LIST

- 1 Funnel
- 2 Measuring cup 700ml
- 3 Steam gun with hose and connector
- 4 Accessory tool adapter
- 5 Jet nozzle attachment
- 6 Detail scraper
- 7 Nylon brush grout
- 8 Nylon brush medium
- 9 Nylon brush large
- 10 Metal brush small brass
- 11 Metal brush large brass
- 12 Metal brush large stainless steel
- 13 Cotton cover
- 14 Large elbow adapter
- 15 Floor head smooth surface
- 16 Water level dip stick
- 17 MR-750 Ottimo Main Unit
- 18 Extension tubes x 2
- 19 Detail jet tool
- 20 Bed bug / fabric tool

- 21 Micro fiber floor pad
- 22 Accessory storage bag
- 23 Replacement o-ring set
- 24 Horse hair brush small
- 25 Horse hair brush large

TECHNICAL SPECIFICATIONS

Model: MR-750 Ottimo
 Power supply: 120V 60Hz
 Heating element: 1600w - 13AMP
 Steam Pressure: 5.2BAR - 75PSI MAX
 Boiler capacity: 4LTR - 1GAL
 Heating time full: 20 MIN.
 Boiler temp: 160C - 320F
 Steam temp at tip: 140C - 284F PEAK
 Power cord length: 15'
 Steam hose length: 8'
 Gross weight: 9KG - 20LBS

GETTING STARTED

GO TO VAPAMORE.COM TO SEE THE MR-750 OTTIMO INSTRUCTIONAL VIDEO

Once unpacked the only items that need to be installed are the cord hooks and the storage basket. All the necessary tools and hardware are included to install these items.

Fig.1

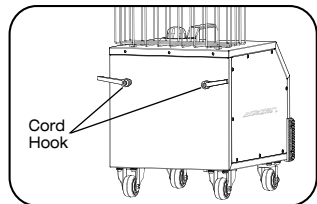

CORD HOOKS

There are two supplied cord hooks that are mounted by threading the cord hooks onto the threaded studs located on the back of the steamer housing. The cord hooks rotate by pulling outward from the steamer then twisting to rotate. Use this rotate function to easily remove the power cord and to position the hooks for cord storage. Use the Velcro cord strap to secure the cord during transport. (Fig.1)

Fig.2

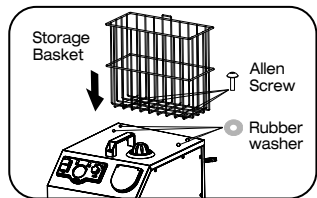

STORAGE BASKET

The basket is secured to the main steamer body using the 4 supplied Allen head style screws and rubber washers. Align the basket screw hole locations and with the rubber washer between the basket and the steamer housing, insert the Allen head screws loosely until all screws are in place. Once all screws are in place secure all screws firmly with the supplied Allen tool. (Fig.2)

⚠ NOTE: If the storage basket is not being installed make sure to use the 4 supplied Allen head screws to plug the storage basket mounting holes in the steamer housing. This will prevent water or debris from entering the steamer housing.

⚠ NOTE: Always test the steam cleaner first on inconspicuous or invisible areas of the surfaces or fabrics to be cleaned to check their tolerance to hot steam. Steam may result in bleaching of painted / varnished wood. Steam may discolor shiny plastics. Acrylic, velvet and linen react very sensitively to the hot steam.

⚠ NOTE: Vapamore cannot be held responsible for damage to objects, materials, people, animals or plants that occurs due to unsuitable use of hot steam or due to improper use of the appliance.

⚠ NOTE: The **Ottimo** is fitted with an overheating cut-out. The steam cleaner switches off automatically if over pressure or over temperature is detected.

⚠ IMPORTANT: The housing and accessories become hot during operation. Allow the machine to cool down before removing tank cap or when changing accessories.

⚠ IMPORTANT: Always ensure the steamer is on a level floor or flat surface when in operation. Do not tip or tilt the steam cleaner during use.

ACCESSORIES AND TOOLS

GO TO VAPAMORE.COM TO SEE THE MR-750 OTTIMO INSTRUCTIONAL VIDEO

Fig.1

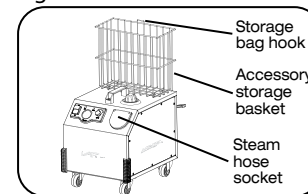

ACCESSORIES

The MR-750 Ottimo has an accessory storage basket and storage bag. Once all the accessories have been unpacked use the accessory storage bag and basket to carry all the accessories. The storage bag can be hung on the loop on the back of the storage basket. (Fig.1)

Fig.2

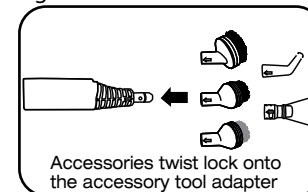

The accessory tool adaptor (#4 on parts overview page) is required when using the jet nozzle attachment, detail scraper, and all round detail brushes. Align the accessory with the arrow on the accessory tool adaptor and twist to lock into place. The accessory tool adaptor can be used directly on the steam gun or can be used with the extension tubes. (Fig.2 & 3)

Fig.3

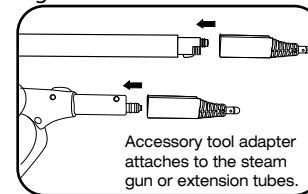

The large elbow adaptor (#14 on parts overview page) is required when using the floor head (#15 on parts overview page). With the large elbow adapter facing down, insert into the floor head until completely inserted then rotate up. The adapter will only insert when facing down and then locks into position and allows the adapter to rotate when in use. The large elbow adapter can be used directly on the steam gun or with the extension tubes. Always use the micro fiber pad with the floor head. Wrap the micro fiber pad around the ends of the floor head and hold in place under the spring clips. (Fig.4)

Fig.4

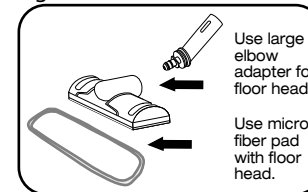

The detail jet tool and the bed bug / fabric tool (19 & 20 on parts overview page) can be connected directly to the steam gun or the extension tubes. (Fig.5)

Fig.5

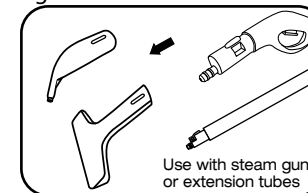

STEAM GUN / EXTENSION TUBES

The steam gun connects to the steam socket located on the front panel of the machine. Flip the dust cover open and push the hose connector firmly into the socket until both tabs click into place. Remove the steam hose by pressing in both release tabs while pulling out. (Fig.1)

Fig.6

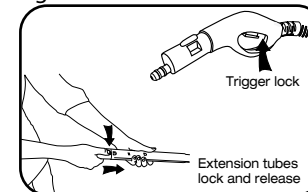

The steam gun has a trigger (ON) lock located just behind the trigger. This lock can be used for continuous steam without having to hold the trigger. To set the lock, push down the trigger, then while the trigger is down slide the lock to hold the trigger.

Extension tubes can be used for floors or difficult to reach areas. The extension tubes push and lock into place on the steam gun. (Fig.6)

FILLING & OPERATION

GO TO VAPAMORE.COM TO SEE THE MR-750 OTTIMO INSTRUCTIONAL VIDEO

To fill the water tank, switch the steam cleaner off and remove the plug from the wall outlet. Allow steam cleaner to cool down before removing water tank cap. Unscrew the water tank cap (Fig. 1) by pressing the cap down and simultaneously turning counter clockwise. Check the water level with the supplied dipstick. Use the supplied funnel and 700ml measuring cup to fill to the desired level. From a completely empty tank use the fill chart to fill to the level to fit your work needs. NOTE: Never fill more than 2800ml.

Fill chart for working and heating times (water amount -working time - heating time):
700ml - 30-45min. - 5-7 min. / 1400ml - 60-80 min. - 10-12min. / 2100ml - 90-120 min.
- 15-17min. / 2800ml - 150-180min. - 20-22min. (Measuring cup has a 700ml full mark)

Fig.1

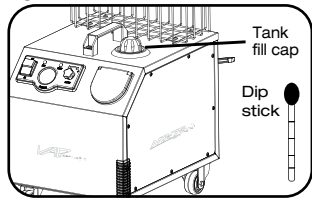

⚠ IMPORTANT: Always use the dipstick to check the water level. DO NOT overfill past the FULL mark, 2800ml. If so drain excess water by removing the drain plug to achieve desired water level. The dipstick has 4 marks, 100% - 2800ml, 75% - 2100ml, 50% -1400ml, 25% - 700ml. This allows options for working time and heating wait time.

Fig.2

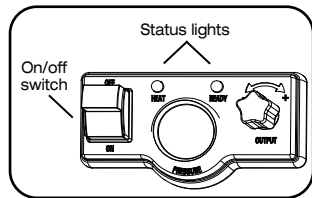

⚠ IMPORTANT: Make sure steamer is completely cooled before removing the cap to fill with water. Opening the cap while the steamer is hot can cause scalding and severe burns.

⚠ IMPORTANT: Only fill with distilled water without additives of any kind, such as perfumes or cleaning agents. Using hard water will void the warranty and cause failure.

Replace the water tank cap by pressing down on the cap and simultaneously turning it clockwise. Make sure the cap is fully tight to prevent any steam from leaking out. If steam leaks from the cap area turn the machine off and once cooled down tighten the cap fully.

Plug the steamer into a wall outlet and switch on by pressing the on /off switch to the "on" position. The red status light will illuminate when the power switch is on indicating the water is heating. The green status light will illuminate indicating the water is fully heated and ready for use. The green status light will cycle on and off during use indicating the heater turning on and off to maintain full working temperature. (Fig.2)

⚠ IMPORTANT: Once the green light illuminates the steamer is ready for use. The green light will cycle on and off as the heater turns on and off during use. **Continue to use the steamer as you normally would as the green status light cycles on and off.**

Fig.3

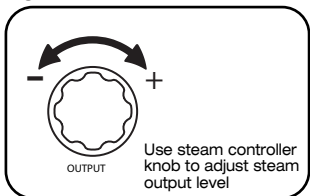

The flow rate of the steam emitted can be regulated by turning the steam controller and can be adjusted to the level required. Turn the controller knob clockwise to increase the steam output and counter clockwise to reduce the steam output. (Fig.3)

OPERATION

GO TO VAPAMORE.COM TO SEE THE MR-750 OTTIMO INSTRUCTIONAL VIDEO

Fig.1

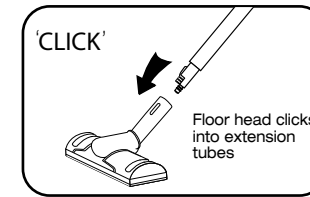

FLOOR CLEANING HEAD

Attach the floor cleaning head to the end of the extension tube (use 1 to 2 tubes as desired). Ensure that the floor cleaning head clicks into place. (Fig.1)

The floor head smooth surface is used with the micro fiber pad for hard surface areas. Place the floor cleaning head on the micro fiber pad and secure the overhanging material under the clips located on each side of the floor cleaning head. (Fig.2)

Fig.2

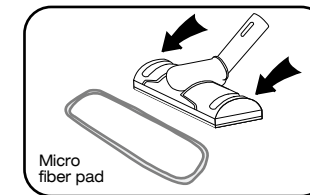

The floor head smooth surface is ideal for stone, tile, vinyl and wood floors along with cleaning washable walls and any hard surface. It can also be used to sanitize, deodorize, kill allergens, bed bugs and dust mites. Attach the micro fiber pad to allow the floor cleaning head to glide when using on carpet. (Fig.3)

Fig.3

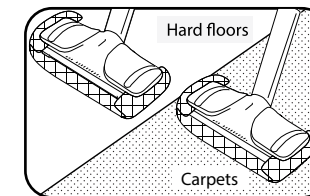

DETAIL JET TOOL / JET NOZZLE

The detail jet tool can be attached directly to the steam gun or to any of the extension tubes. The jet nozzle attachment is used with the accessory tool adapter.

These tools are great for removing soap scum in the bath, shower, and faucets. Also for cleaning tight areas such as toilet seat hinges where high pressure steam can reach and blow out dirt and debris. These tools are most effective when applied direct to the surface being cleaned. The steam temperature will condense and cool within 1" of the tool tip. (Fig.4)

Fig.4

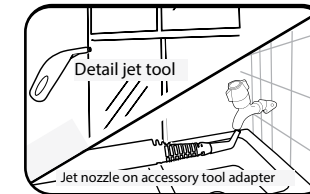

OPERATION

GO TO VAPAMORE.COM TO SEE THE MR-750 OTTIMO INSTRUCTIONAL VIDEO

Fig.1

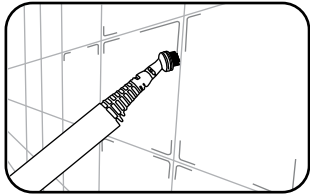

BRUSHES

There are 8 brush types supplied with the Vapamore MR-750 Ottimo. The brushes attach to the accessory tool adapter by aligning the arrows and twisting to lock. Suggested uses (Metal brushes), Oven grills, BBQ grates, cement stains, machinery, and metal surfaces. (Nylon medium duty and large nylon brush), used for more sensitive materials such as blinds, carpet, furniture, air vents, shoe scuffs, soap scum. (Nylon grout brush), this brush is used for harder less sensitive areas such as grout lines on tile floors, stone, cement, and machinery. (Horse hair brushes) These brushes are used for sensitive surfaces such as delicate materials, car interiors, and fabrics. (Fig.1/2)

Fig.2

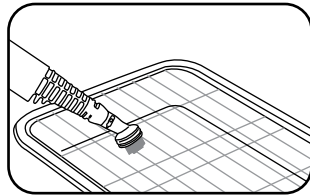

⚠ IMPORTANT : With all brushes it is important to not apply excessive pressure or force. This can cause failure of the detail adaptor or related parts. When using the brushes let the steam do the work and the brush to help agitate the stain or area being cleaned. (Fig.1/2)

Fig.3

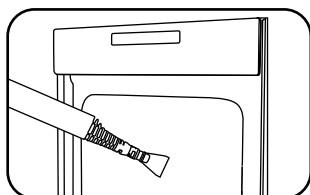

SCRAPER TOOL

The scraper tool can be used to defrost freezers, on oven walls and cook top surfaces to remove stuck on food. This tool is also good for removing wall paper, paint and shelve paper and gum. (Fig.3)

Fig.4

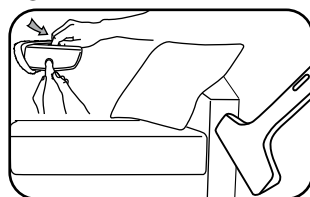

BED BUG / FABRIC TOOL

Start by installing the supplied cotton cover on the Bed bug / fabric tool. Now this tool can be used for steaming and sanitizing along with eliminating odors in garments, fabrics, furniture, curtains, drapes, etc. (Fig.4)

Bed bugs, allergens and mold:
Use this tool on bedding, pillows, and furniture by applying light pressure and slowly passing it along the surface to kill Bedbugs, dust mites and other allergens. (See bed bug - dust mite - allergens page for details) (Fig.4)

BEDBUG - DUST MITES - ALLERGENS

GO TO VAPAMORE.COM TO SEE THE MR-750 OTTIMO INSTRUCTIONAL VIDEO

WHY USE STEAM?

The Vapamore MR-750 Ottimo produces steam with an output temperature between 210° to 240° degrees. Pests such as bedbugs, dust mites and other allergens along with their eggs are killed on contact at a temperature of 180° degrees. Using steam is an extremely effective and chemical free way to kill these pest along with E. Coli, Salmonella, H1N1 and other bacteria or viruses without leaving any harmful chemical residue behind. The tools supplied with the Vapamore MR-750 Ottimo allow you to treat all areas where these pests can hide such as bedding, sofas, furniture, pillows, carpet, cracks and crevices that are ideal hiding places for pests.

BEDDING / FURNITURE

Fig.1

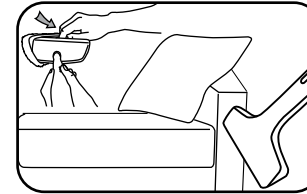

The bed bug / fabric tool with cotton cover is ideal for treating bedding, furniture, pillows, and carpet areas around bed posts and base boards. Start by installing the supplied cotton cover on the clothes - fabric / smooth surface tool. Apply light consistent pressure and slowly pass it along the surface (1" per second) to ensure the area being treated has a chance to come to full temperature killing pests and their eggs. (Fig.1)

Fig.2

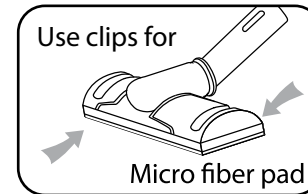

The floor cleaning head with micro fiber cover is also great for treating large surface areas such as bedding, furniture, and carpet areas. Start by installing the supplied micro fiber cover on the floor cleaning head. The micro fiber cover thermal core maintains full temperature during use and allows the floor cleaning head to glide over fabric or carpet. (Fig.2)

Fig.3

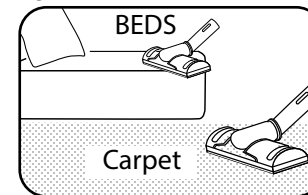

Apply light consistent pressure and slowly pass it along the surface (1" per second) to ensure the area being treated has a chance to come to full temperature, thereby killing pests and their eggs. (Fig.3)

Fig. 4

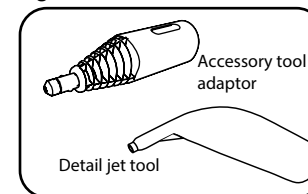

The accessory tool adaptor or the detail jet tool can be used on their own. These tools are great for cracks and crevices. Make sure to concentrate the steam directly on the area to be treated with as minimal distance as possible. The steam will condense and cool off and will not kill pests and their eggs if the jet tip is not directly on the surface being treated.

The accessory tool adaptor or the detail jet tool can be attached directly to the steam gun or to any of the extension tubes. (Fig.4)

CLEANING /STORAGE

GO TO VAPAMORE.COM TO SEE THE MR-750 OTTIMO INSTRUCTIONAL VIDEO

CLEANING / MAINTENANCE

Always ensure before cleaning or maintaining the Vapamore MR-750 Ottimo that it is switched off and unplugged from the wall outlet and cooled down completely.

Only clean the outer surface with a water moistened cloth. Do not use any cleaning agents, abrasives or alcohol since they may damage the housing finish.

The included micro fiber cover and cotton cover can be machine washed using normal detergents and wash cycle. *Air dry dry only, do not use any fabric softeners as these will leave a residue on the pad and cause cleaning issues when using the pad.

BOILER TANK & DRAIN

⚠ IMPORTANT: Only fill with distilled water without additives of any kind, such as perfumes or cleaning agents. Using hard water will void the warranty and cause failure.

Fig.1

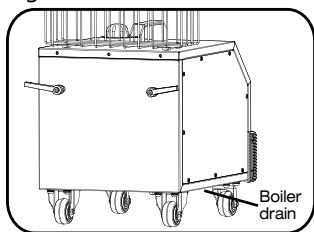

The boiler should be emptied before storing for any extended period of time (30 days or more) or emptied every 3 months of use to help flush out and remove any debris that may have collected in the boiler. Make sure the steamer is unplugged and completely cooled down before emptying the boiler. The boiler drain is located on the underside of the steamer. The steamer MUST be 100% cooled down and have no pressure stored in the boiler to remove this cap. With the supplied tool, remove the drain cap to drain the boiler then replace and tighten the cap. Do not overtighten the cap as you may damage the seal. (Fig.1)

⚠ IMPORTANT: Never ship or transport the machine with water in the boiler tank. The boiler tank MUST be completely emptied prior to shipping or transporting the machine. Failure to do so can cause water to enter the machines internal parts and void the warranty.

ACCESSORIES

Make sure all the o-rings are in place on the accessory tools and adapters. A silicon lube can be used on these o-rings to help maintain a long use life.

Parts, extension tubes and accessories can be stored in the supplied accessory storage bag and the storage basket located on the back of the steamer. The steam gun and hose can remain plugged into the steamer and also be stored in the storage basket.

Replacement accessories and parts are available to order online at vapamore.com or by calling Vapamore at 480-951-8900.

TROUBLESHOOTING

GO TO VAPAMORE.COM TO SEE THE MR-750 OTTIMO INSTRUCTIONAL VIDEO

PROBLEM?

What do I do if the machine or an accessory becomes damaged or broken? Visit www.vapamore.com for a complete list of parts and accessories available for purchase or simply call us at 480-951-8900 or e-mail us at info@vapamore.com to purchase replacement parts or schedule a repair. "WE ARE HERE TO HELP."

⚠ IMPORTANT : Do not return to the place of purchase for warranty or repairs. Only Vapamore is authorized to facilitate all repairs to keep the highest quality and ETL standards. Repairs or tampering by any other party will void the Warranty.

TROUBLESHOOTING

PROBLEM: Operating pilot lamp fails to light.

Cause: The steam cleaner is not plugged into a socket or is not switched on.

Solution: Insert the main plug into a socket or switch the steam cleaner on.

Cause: The socket is faulty.

Solution: Check the socket by unplugging the steam cleaner and plugging in to a different known good socket.

Cause: One of the ETL protection devices has been triggered or the power cord has been damaged.

Solution: Call us at 480-951-8900 or E-mail us at info@vapamore.com to schedule a repair.

PROBLEM: No steam is emitted when the steam button is pressed.

Cause: The steam adjust dial is turned "off" (counter clockwise)

Solution: Turn the steam adjust dial to "on" (clockwise)

Cause: The water tank is empty.

Solution: Fill in water.

PROBLEM: Only a very small amount of steam flows out.

Cause: The steam controller is set to minimum.

Solution: Turn the steam controller clockwise until sufficient steam is emitted.

Cause: The internal parts have been clogged by debris or hard water build up.

Solution: Call us at 480-951-8900 or e-mail us at info@vapamore.com to schedule a repair.

PROBLEM: The steam cleaner takes a very long time to heat up.

Cause: The tank could have a build up of lime scale due to the use of hard water.

Solution: The tank will need to be replaced due to hard water damage. Contact Vapamore at 480-951-8900 or info@vapamore.com to schedule service.

⚠ IMPORTANT : DO NOT ATTEMPT TO USE ANY CHEMICALS OR CLEANERS INSIDE THE TANK. The tank uses high heat and pressure, this combined with a chemical of any type can be explosive and destroy the machine and can cause personal injury or death.

TIPS

GO TO VAPAMORE.COM TO SEE THE MR-750 OTTIMO INSTRUCTIONAL VIDEO

APPLICATION	STEAM VOLUME	ATTACHMENT	TECHNIQUE
FLOORS / CHEMICAL FREE CLEANING WITH NO RESIDUE LEFT BEHIND			
Vinyl Tile Or Vinyl Sheet	Medium - High	Floor Cleaning Head + Micro fiber + Extension Tubes + Nylon Brush.	Sweep or vacuum first. Steam mop with floor cleaning head and micro fiber cover. Corners and baseboards with nylon brush.
Stone Tile, Slate, Ceramic Tile, Grout	High	Floor Cleaning Head + Micro Fiber + Extension Tubes + Nylon Brush + Grout Brush + Nylon Brush Jet Nozzle	Sweep or vacuum first. Steam mop with floor cleaning head, heavy stains use without micro fiber cover. Corners and baseboards with nylon brush. Grout lines use grout brush and / or jet nozzle. Finish with floor cleaning head / micro fiber cover.
Smooth Surface Concrete	High	Floor Cleaning Head + Micro Fiber + Extension Tubes + Grout Brush + Nylon Brush + Metal Brush + Jet Nozzle	Sweep or vacuum first. Steam mop with floor cleaning head, heavy stains use without micro fiber cover. Corners and baseboards with nylon brush. Joint lines use grout or metal brush and / or jet nozzle. Finish with floor cleaning head / micro fiber.
Hardwood	Low - Medium	Floor Cleaning Head + Micro Fiber + Extension Tubes	Sweep or vacuum first. Steam mop with floor cleaning head and micro fiber cover.
CARPETS / SPOT TREATMENT			
Wall To Wall, Rugs, Spot Care	High	Nylon Brush + Jet Nozzle + Paper Or White Cotton Towel	Vacuum area first then steam using brush or jet. Use towels to blot stain away. Chemical cleaner can be used prior to steam treatment.
CARPETS / DEOTERIZE + KILL BEDBUGS - DUST MITES AND ALLERGENS			
Wall To Wall, Rugs	High	Floor Cleaning Head + Extension tubes + Micro Fiber + Jet Nozzle	Vacuum area first then steam using floor cleaning head with micro fiber cover. Pass slowly over area to allow heat to kill pests. Use jet nozzle for corners and cracks.
WALLS, CEILINGS			
Painted, Wood Paneling, Wallpaper	Low - Medium	Floor Cleaning Head + Extension tubes + Micro Fiber + Nylon Brush + Clothes / Fabric tool with cotton cover.	Painted, wood paneling, wallpaper walls are heat sensitive. Always test small area first and be careful not to over heat finish. Use Floor Cleaning head with micro fiber cover or clothes steamer with cotton cover. Use nylon brush for corners and stains.
Wallpaper Removal	High	Nylon Brush, Jet Nozzle, Extension Tubes + Smooth Surface Tool + Scraper	Use at full power to soften glue and remove wallpaper. Wallpaper stripper can be applied first.
Air Vents	Medium -High	Nylon Brush, Jet Nozzle, Extension Tubes, Cotton Towel	Clean using brush and jet tip. Wipe down with clean cotton towel.
UPHOLSTERY / SPOT TREATMENT			
Vinyl, Synthetic, Cotton	Medium - High	Nylon Brush, Jet Nozzle, Clothes Steamer, Cotton Cover, Cotton Towel	Test a small area first. Some synthetic materials will not handle high heat. Use nylon brush with soft pressure for larger stains and jet tip for small stains. Blot with cotton towel. Use clothes steamer with cotton cloth to go over all surfaces to deoterize.
Leather	Low	Clothes Steamer, Cotton Cover, Cotton Towel	Test a small area first. Steam over stained area and then blot with cotton towel. Use clothes steamer with cotton cloth to go over all surfaces to deoterize.
UPHOLSTERY / KILL BEDBUGS - DUST MITES AND ALLERGENS			
Vinyl, Synthetic, Cotton	Medium - High	Jet Nozzle, Clothes Steamer, Cotton Cover	Test a small area first. Some synthetic materials will not handle high heat. Use clothes steamer with cotton cover and slowly pass over area to allow heat to kill pests. Use jet nozzle for cracks and corners.

TIPS

GO TO VAPAMORE.COM TO SEE THE MR-750 OTTIMO INSTRUCTIONAL VIDEO

APPLICATION	STEAM VOLUME	ATTACHMENT	TECHNIQUE
WINDOW BLINDS			
Levolor, Venetian, Horizontal, Vertical	Low-Medium	Nylon Brush, Jet Nozzle, Detail Nozzle, Extension Tubes, Cotton Towel	Dust area first. Thin plastic blinds may not be able to handle heat from the steam. Test a small area first. Use jet or detail nozzle from 4" away. Wipe off with cotton towel.
GLASS			
Windows, Mirrors	Medium	Smooth Surface Squeegee, Extension Tubes, Nylon Brush, Paper Towels	Pre-steam glass from 6" away to heat glass. Use brush for edges and bases. Finish with window cleaner squeegee. Do not use if temperature is under 32 degrees to prevent cracking.
Window Screens, Window Frames	Medium -High	Detail Nozzle, Nylon Brush, Extension Tubes	Steam area with detail nozzle. Use brush for edges and corners.
KITCHENS			
Stove Tops, Ovens	Medium - High	Nylon Brush, Brass Brush, Extension Tubes, Paper towels	Use nylon brush over all surfaces and brass brush for interior oven grates. Wipe down with paper towels
Small Appliances	Medium	Nylon Brush, Detail Nozzle, Paper towels	Use brush over all areas and detail nozzle for small corners and seems. Wipe down with paper towels.
Sinks, Faucets, Drains	Medium - High	Nylon Brush, Detail Nozzle, Paper towels	Use brush over all areas and detail nozzle for small corners and seems. Wipe down with paper towels.
Counter Tops	Low- Medium	Smooth Surface Squeegee, Nylon Brush, Detail Nozzle, Paper towels	Use brush over all areas and detail nozzle for small corners and seems. Use smooth surace squeegee to sanitize counter tops by slowly passing over area then wipe area with paper towel for chemical free cleaning.
BATHROOM			
<small>(NOTE: HARD WATER AND CALCIUM STAINS CAN ONLY BE REMOVED WITH CHEMICALS.)</small>			
Tile, Grout	Medium - High	Floor Cleaning Head + Micro Fiber + Extension Tubes + Grout Brush + Jet Nozzle	Sweep or vacuum first. Steam mop with floor cleaning head, heavy stains use without cotton cover. Corners and baseboards with nylon brush. Grout lines use grout brush and / or jet nozzle .Finish with floor cleaning head with micro fiber.
Porcelain Toilets, Chrome Fixtures	Medium - High	Nylon Brush, Detail Nozzle, Paper towels	Use brush over all areas and detail nozzle for small corners, hinges, and seems. Wipe down with paper towels.
Shower, Tubs, Doors	Medium	Nylon Brush, Detail Nozzle, Extension Tubes, Paper towels	Use brush over all areas and detail nozzle for small corners and seems. Wipe down with paper towels.
AUTO, MOTORCYCLE, MARINE			
Interior Areas	Medium - High	Nylon Brush, Jet Nozzle, Clothes Steamer, Cotton Cover, Cotton Towel	Test a small area first. Some synthetic materials will not handle high heat. Use nylon brush with soft pressure for larger stains and jet tip for small stains. Blot with cotton towel.
Detailing, Exterior, Engine	Medium - High	Nylon Brush, Detail Nozzle, Jet Nozzle	Use brush over all areas and detail nozzle for small detail areas.

NEED HELP?

Visit www.vapamore.com to see video demonstrations and tips along with full details or simply call us at 480-951-8900 or E-mail us at info@vapamore.com
WE ARE HERE TO HELP..



Lifetime Limited Warranty for the Vapamore MR-750 Ottimo Steam Cleaner

(Overview and terms of the Limited Lifetime Warranty)

Coverage:

1: Lifetime parts and labor on the boiler, heating element and all internal electronics.
The Vapamore MR-750 Ottimo Steam Cleaner boiler tank, heating element and all internal electronic parts are lifetime warranted to be free from defects in material and workmanship when utilized by the original purchaser only. This warranty does not cover damage due to hard water calcium or mineral build up on internal parts including but not limited to the boiler, heating element, solenoid, pump, internal valves and fittings.

2: One (1) year parts and labor on accessories and housing.
The Vapamore MR-750 Ottimo Steam Cleaner accessories and housing are warranted to be free from defects in material and workmanship for a period of one (1) year from the date of purchase when utilized by the original purchaser only. This does not include replacement of items due to wear including but not limited to the Floor Brush, Nylon Brush, Grout Brush, Metal Brush, Jet tip, Clothes Steamer Cotton Cover, Floor Brush Cotton / Micro Fiber Cover.

For this warranty to apply the original purchaser must return the warranty registration form (included in the original packaging or available online at vapamore.com) along with a copy of the original purchase receipt to Vapamore 7343 E. Adobe Drive Suite 140, Scottsdale, AZ 85255 within 15 days from the original purchase date.

Should any defect covered by the terms of this lifetime limited warranty be discovered, Vapamore will repair or replace any defective part provided the unit is returned by the original purchaser listed on the warranty form on file.

The liability under this warranty is limited solely to the cost of the replacement parts or the complete unit at the discretion of Vapamore. This warranty is void if damage is resulting from accident, misuse, improper operation, unauthorized repair or alteration, tampering, substance other than clean water used in the boiler tank, hard water calcium or mineral build up, or damages accruing in transit. This warranty does not cover any shipping fees to or from our facility.

This warranty is extended to the original purchaser only and excludes all other legal and / or conventional warranties. The responsibility of Vapamore, if any, is limited to the specific obligations expressly assumed by it under the terms of the lifetime limited warranty. In no event is Vapamore liable for incidental or consequential damages of any kind whatsoever.

Customer is responsible for all shipping fees to and from our facility. Carefully pack returning items for repair to avoid damage in transit. Main water tank must be empty of all water before shipping. Failure to do so will void this warranty. Be sure to include in the box all your contact information including name, phone number, e-mail address and shipping address along with a prepaid return ship tag from UPS or Fed Ex. Vapamore does not ship and will not accept items sent via USPS. Contact Vapamore at 480-951-8900 or e-mail customersupport@vapamore.com for making arrangements to return items for repair or service. Vapamore is not responsible for any shipping cost to or from our facility.

Vapamore®
tel. 480-951-8900 / fax. 480-951-8902
www.vapamore.com



Vapamore®

THE LOVE OF STEAM

Vapamore
7343 East Adobe Drive, Suite 140
Scottsdale, AZ 85255